



THE VALLEY VIEW

Newsletter of the Greater Madison Valley Community Council

Issue 159

madisonvalley.org

November 2008

One of Our Neighbors: Margot Publishes Her First Book

By Cathy Nunneley



Margot Kahn

One fine day, Margot Kahn was returning from a casual neighborhood walk with an old friend when she stopped at her mailbox. She expected to retrieve the usual, rather boring missives. Instead, she found a delivery that has changed her life forever. Margot has now officially joined the rarified ranks of published book authors.

Margot smiled as she retold with pleasure the joy of receiving the first notice of acceptance by a publisher for her biography, *Horses That Buck: The Story of Champion Bronc Rider Bill Smith*. It had been over a year since Margot sent off her manuscript to several publishers for consideration. And, it had been over seven years since she began the story of Bill Smith. The experience of receiving the notice of acceptance was greatly enhanced since she was able to share the news with her good friend, who was also a professional writer. Margot knew she wanted to be a writer at a very young age—even before she could actually write. As a preschooler, she worked alongside her artist mother in their home studio. Margot would draw pictures and tell stories. As an English major in college, Margot took a few creative writing courses, but reports that she actually spent most of her time reading.

After graduation, Margot relocated to Seattle with a friend. She found work at the *Jewish Transcript* writing obituaries, developing the calendar, and eventually writing feature articles. Graduate school beckoned and she applied to several institutions with the intention to study fiction writing. However, that plan was deferred when she met Cody Bill Smith.

Margot was enjoying a family vacation at a dude ranch in Colorado when she was befriended by the famous bronc rider, Bill Smith. He was already retired from rodeos and working at gentling horses and teaching riding skills to others. By the end of the vacation, she realized there was a story to be told about Bill's rodeo life, and she was meant to write it.

Margot spent the next year researching her subject and later went to Columbia University to study writing where many mentors assisted and supported her. She spent most of her vacation time with Bill, his family, and friends. "All those years of work have paid off," Margot explains. "It's really exciting to have a book after so many years of dreaming about it!"

Horses That Buck is more than a story of a rodeo star. It's an ac-

⇒ Please see *Margot's Book* on page 2

Now is the Time to Get Involved and Make Your Voice Heard!

Adrienne W. Bailey, Chair
Central Area Neighborhood Plan Stewardship (CANPS)

On September 22, 2008, City Council adopted a resolution establishing a Neighborhood Plan Advisory Committee. This committee will be responsible for reviewing the status of existing Neighborhood Plans and determining whether updates to certain Neighborhood Plans are warranted and desired by the residents of the respective neighborhoods. The City has already established that they will first concentrate on updating Neighborhood Plans with communities that have light rail transit stations, so the Southeast has first priority and the City will not be coming to the Central Area to update our plan for a while. However, this delay will give our community time to get ahead of this process and work on our plan so that by the time the City gets to us, we will have most, if not all, of the work done.

To start updating our Central Area Neighborhood Plan, committees need to be formed to address the various elements of our Plan. Those elements are as follows: Land Use and Open Space; Urban Design; Economic Development; Housing; Transportation; Human Development; Infrastructure; Capital Investments; and Plan Implementation. The committees focused on these elements may be formed separately or may be combined. So far this year, a combined Land Use, Open Space, and Housing Committee has been meeting on issues such as, but not limited to, zoning and re-zoning, multifamily development, incentive zoning, and working

⇒ Please see *Neighborhood Plan* on page 3



Events Calendar

Madison Valley Merchants Association. Wednesday, November 12, 8:30 a.m. Café Flora, 2901 E. Madison St.

Greater Madison Valley Community Council. Wednesday, November 19, 7:30 p.m. Bush School (entrance on E. Harrison St. and 34th Ave. E.)

Clean Up MLK. Saturday, November 22 from 9:00 a.m. to 11:00 a.m. Martin Luther King, Jr Elementary School. See p. 8.

Land Use, Open Space, and Housing Committee. November 17, 6:30 p.m. Madrona Shelter House (34th Ave E. and E. Spring St.). See article above.

School Use Advisory Meeting. November 20, 7:30p.m. T.T. Minor Elementary School (17th Ave E. and E. Union St.). See p. 6.

Central Area Neighborhood Plan Stewardship. December 4, Garfield Community Center (23rd Ave E and E Cherry St). See article above.

GMVCC ID Statement

The Valley View

November 2008, Issue 159 · www.madisonvalley.org
published nine times a year by the

Greater Madison Valley Community Council
P.O. Box 22278, Seattle, WA 98122

Member of the Seattle Community Council Federation

2007-2008 GMVCC Officers

President: Peter Triandafilou · president@madisonvalley.org · 720-0488

Vice President: Charles McDade **Secretary:** Lindy Wishard

Treasurer: Peter Triandafilou (temporary)

Newsletter Staff

Editor: Ann McCurdy · editor@madisonvalley.org · 568-7372

Copyeditor: Serin Ngai

Layout: Frank Lawler

Advertising: Frank Lawler

Article submissions due by the 25th of each month

Monthly ad rates:

\$35 (approx. 2" x 3.5") · \$80 (1/4 page) · \$150 (1/2 page)
preferential placement for extra fee (if available)

*Circulation 2,200 / Yearly discounts available
contact advertising@madisonvalley.org · 568-7372*

Margot's Book, continued from p. 1

count of a man who matured from a thrill and fame-seeking youngster into an introspective "horse whisperer." It wasn't until he retired from rodeo that Bill realized he did not have a true understanding of horses. He sought to rectify that deficiency and, in the process, was able to channel his newfound love and respect for horses into a second career as a horse whisperer. Margot has not only been able to capture that transition in her storytelling, but she has also left Bill with a lasting legacy to his lifelong passion—a true gift.

Nowadays, Margot spends her spare time driving around the West promoting her book in small horse and rodeo towns. She is happily employed creating programs for young writers at the Richard Hugo House here in Seattle. And, another writing project is in the works. What's it all about? Margot just smiles and says, "I'm only saying it's a novel set in the West."

Margot's book is available at local stores such as Elliot Bay Books, on Amazon.com, and at the library. Congratulations, Margot! We certainly look forward to the next book. 

ART CLASSES *Thrive*
ART SCHOOL



- ▶ **LEARN MORE & REGISTER**
www.drawingschool.com
- ▶ **TWO SEATTLE LOCATIONS**
Ravenna & Madison Valley
206.522.1659

Try one of our **FREE** Introductory Classes



Laurie M. Greig, Ph.D.
Psychotherapist
Children, Adolescents, Adults
Individuals and Families
206.963-6666

511 28th Avenue East • Seattle, WA 98112
Dr.LaurieGreig@comcast.net

aNISE Graphics 

ANISEGRAPHICS.COM :: 206.387.6021
LOGO DEVELOPMENT :: MARKETING STRATEGIES
PRINT :: PACKAGING :: ENVIRONMENTAL :: WEB

seattle LAW OFFICE

- WILLS & PROBATE
- FAMILY LAW
- TAXES
- LAWSUITS
- REAL ESTATE
- SMALL BUSINESS

Peter A. Triandafilou, Esq.
Madison Valley's resident attorney since 1993
(206) 720-0488
www.Seattle-Law-Office.com

ADULT IN HOME CARE SERVICES
Hyatt Home Care Services

In-Home Care Aides assisting with non-medical tasks & home support needs:

Housekeeping • Personal Care • Meal Preparation
Respite Care • Pet Care • Errands • Companionship

Call 206.851.5277 or care@hyatthomecare.com
Washington State Licensed Home Care Agency

BAILEY Boushay HOUSE

AS one of our volunteers, you'll have the opportunity to be a light in the lives of people living with AIDS/HIV.

contact: David Pavlick
at 720-2260

www.virginiamason.org/bailey-boushay

GMVCC Meeting Minutes • October 15

By Lindy Wishard, Secretary

Potluck Dinners: Thanks to Vice President Charles McDade for bringing this idea to life! The Council approved supporting neighborhood potluck dinners. The first potluck dinner will be held at the home of Adrienne Bailey on January 1, 2009. The event will start at 2:30 p.m. and go into the evening. Contact Adrienne at kismet_2000@yahoo.com. Subsequent potluck dinners will be held the last Saturday of each quarter: January 31, April 25, July 25, and October 31. These dinners will be held at the Valley School, 4:00 - 7:00 p.m. All guests are encouraged to bring their very best dish!

The Fate of MLK: The School Use Advisory Committee (SUAC) meetings are underway to determine the community's desires related to the future use of MLK, Jr. Elementary School. For more information see p. 6.

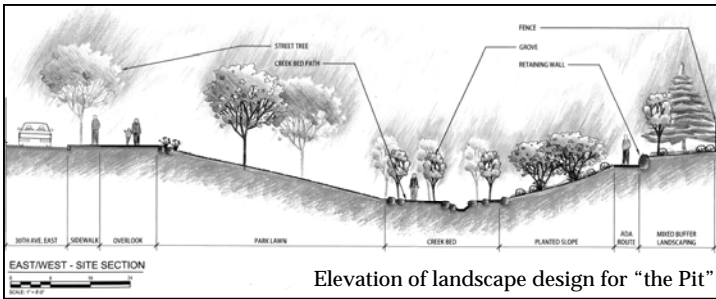

Stormwater Detention Pond: Seattle Public Utilities will hold their second meeting concerning landscape designs for "the Pit" (at 30th Ave. E. and E. John St.) on November 5 at The Bush School. They have updated their original design after receiving feedback from their public meeting held on September 17. They consider their latest design "30% done," and it can be viewed at http://www.seattle.gov/util/About_SPU/Drainage_Sewer_System/Projects/MadisonValleyProject/.

Signs for Events: The Council is in favor of having better signs made to advertise community events (for example, sandwich boards pointing to the location of community council meetings). A quorum, needed to approve the expense, was not present, and so this was not voted on.

Treasurer's Report: Our current balance is \$13,390.42 

Neighborhood Plan, continued from p. 1

on overlays of the various corridors and major streets in the Central Area.

Not everyone is interested in this particular committee, but there are other committees that may interest you, and you can help get them started. For example, several residents have voiced interest in the Economic Development and Human Development Committees. CANPS, which oversees the Central Area Neighborhood Plan, meets at 6:00 p.m. the first Thursday of the month at Garfield Community Center (23rd Ave E and E Cherry St); and the Land Use, Open Space, and Housing Committee meet at 6:30 p.m. the third Monday of the month at Madrona Shelter House (inside the park at 34th Ave E and E Spring St). The next CANPS meeting will be held on November 6 and we will be working on prioritizing the order of forming the other committees, receiving updates from the Land Use, Open Space, and Housing Committee, going through our work plan, and discussing the launching of the CANPS website. 



Miranda Levy
321-9932
levy.miranda@gmail.com

I am unable to drive and am seeking a ride to work. I work Monday through Friday 8AM to 4:30 PM in Mountlake Terrace at 220th Street, Exit #179. I could be a bit flexible with the hours. I will split expenses and can meet you at a convenient location around the neighborhood. Thanks!

Penny Bolton
Rebecca Evans



Windermere

206-819-5643
206-465-4757
pennyb@windermere.com
agentevans@aol.com

www.pennyandrebecca.com

REACH BEYOND

CONVENTIONAL EXPECTATIONS

The Bush School provides an exceptional education that asks students to make the world a better place.



The Bush School

Please Join Us!

Open House
for Grades K-12
Sunday, January 11
1-4 p.m.

FOR MORE INFORMATION:
www.bush.edu or
call Johnica at 206.326.7736



Essential Bakery Café: How Sweet It Is!

By Jen Sorensen

When I moved to Madison Valley, I was charmed by the nearby shops and restaurants, and delighted to find that I'd be a stone's throw away from Essential Bakery Café (2719 E. Madison St). Maybe you've seen Essential's rustic breads in the grocery store; the Wallingford-based bakery distributes their products throughout western Washington. For the atmosphere, though, I like going right to the café on the corner. Essential is my "third place" office—when I need to buckle down and grade a pile of student papers, I find it easier to do with a cup of coffee and (on special occasions) a scone.



Loaves awaiting buyers

This image of Essential as a third place—a neighborhood gathering space—is one that manager Aubrae Filipiak wants to develop. So, if you have a neighborhood book club, knitting circle, or community group, Essential is available to host your event; the space is even available after ordinary café hours. Essential also wants to offer family-friendly social events, such as game nights. Keep your eyes open for future announcements and events!

Essential strives to be a good neighbor in other ways, as well. The company is committed to sustainable practices like using locally-sourced ingredients, many of them organic. They are working toward obtaining compostable take-out containers, and they compost their on-site organic waste. Essential also routinely donates their leftover bread to local food banks and shelters.

But, the Essential Bakery Café is more than just bread! In addition to selling a variety of breads and pastries, the café also offers a short menu of freshly-prepared items like sandwiches. And, over the next few months, the café will offer some special seasonal items. Some of these specialty items, like the pumpkin muffins and sweet perrin bread, are appropriate for everyday eating. (Well, I could eat them everyday!) Other products, like the panetone and Yule log, are festive holiday cakes. Usually 48 hours advance notice is sufficient throughout the holiday season; however, if you want to order a special pie or cake, be aware of their deadlines for Thanksgiving (Friday, November 21) and Christmas (Friday, December 19).

I'll have to admit: sometimes I just like to gawk at the items in the display case. Essential recently acquired Parisian Star Desserts, which gives them a greater variety of those beautiful tarts and pastries. Their partnership with local businesses also extends to the beverages they offer; local roaster Victrola Coffee makes a special "Essential Bakery Roast" to meet the company's high standards.

Even if you're not hungry or thirsty, step into the café to check out their rotating art display. Each month, Essential features the work of one local artist. If you are interested in displaying your work there, call or stop by the café to get on the roster.

Fresh bakery items, relaxed atmosphere, and local artwork—all good reasons to stop by the Essential Bakery Café.



M.E.M. video productions
ARCHIVING FAMILY VIDEOS FROM TAPE TO DVD

Re-live your favorite memories ~ Entertain your family for decades.
Condense that HUGE box of old tapes into a SMALL stack of DVD's.

memvideo.biz (206)851-5097

Yesterday . . .
She was
our patient!

206-324-5389
MADISON PARK
PHYSICAL THERAPY
TherapeuticAssociates

YOUR SAFETY

is too important
to leave to luck.

Visit www.StrategicLiving.org
for the complete self-defense
class schedule
or call 206.920.8882

Self-Defense: The Art of Resilience

Now open **Sundays 8am -- 2pm** at our **Madison Park Shop!**

AROSA
THE WAFFLE CAFE

- Espresso
- Famous Swiss Chocolate Mochas
- European Snack Waffles
- Panini Sandwiches

Madison Park/Arboretum
3121 E Madison St • 206.324.4542

First Hill
1310 Madison St • 206.329.5881

Who We See: Zeke the Springer Spaniel

By Heather Searce



Warren and Zeke

Everyday I see a few of my neighbors out walking their dogs. One of the dogs I look forward to is Zeke, a seven-year-old English Springer Spaniel. His owner, 72-year-old Warren Wallace, is a retired machinist who has lived in Madison Valley for the past 35 years with his wife, Julie, and their two daughters. Warren and Zeke take a daily walk for at least 40 minutes; Springer spaniels are hunting dogs and need plenty of exercise. "They're pretty energetic," said Warren. "It's hard to have an energetic dog in the city. You gotta spend time with them."

When Zeke joined the Wallace family, their daughters were

young, so they wanted a dog with a good temperament. "He loves children and he's very alert, so he makes a great watchdog. He's a very smart dog with a unique personality," Warren described. Zeke also has a little dog swagger. "When Zeke was a puppy he would get in the middle of a hula hoop and hold it in his mouth while he ran around prancing like a Clydesdale. He's never lost that Clydesdale gait, and I think that's why he still holds his head up like that."

When not walking his dog, you might spot Warren riding his bicycle. With all that regular exercise, I'm sure we'll be seeing Warren and Zeke taking their daily walks around the neighborhood for many years to come.



[Editor's Note: This is the start of an occasional series focusing on people (and pets!) whom we often see in Madison Valley. Whom do you see all the time walking their dog or jogging? Let us know, and we'll profile them!]

Lakeview Kids' Dentistry
 Stephen J. Stuehling, DMD, PLLC ✂
 703 34th Avenue Seattle, WA 98122 (206)251-7638
www.lakeviewkidsdentistry.com

MT. BAKER SEWING STUDIO
 Sewing on Sundays
with Miss Eden
 Girls & Boys 8+ up. Create your own clothing and gifts.
 CALL OR EMAIL FOR SCHEDULE
edenseattle@mac.com (206) 851-5097

**CONSCIOUS BODY
 PILATES**
 "I must be right. Never an aspirin. Never injured a day in my life. The whole country, the whole world, should be doing my exercises. They'd be happier."
 — Joseph Hubertus Pilates, in 1965, age 86
 2921 East Madison Street
 (206) 709-CORE (2673) www.709-CORE.com

Giddens School
inspiring children to better their world

formerly
 Happy Medium
 School
 Preschool
 through
 5th grade

**K-5 Open House:
 Tuesday, December 2nd 7:00-8:30 p.m.
 All-School Open House:
 Saturday, January 24th 11:00 a.m. - 2:00 p.m.**

At Giddens School, a strong interdisciplinary, academic foundation prepares children for their 21st century world, linking academic content with critical thinking, communication and leadership skills, and social responsibility.

620 20th Avenue South
 Seattle, WA 98144
 206.324.4847
www.giddensschool.org

**Organic
 Options Now
 Available!**

Designed Dinners
meats made easy
 511 28th Avenue East - www.designeddinners.com
Info.madisonvalley@designeddinners.com
 Visit our website to receive 10% off
 your next visit to our Madison Valley location.
 Enter Gift Certificate: #DD08082451919

MLK Community Center Moving Forward

By Andy Engelson

Our grassroots movement to create a center for community, cultural interaction, lifelong learning, and the arts at the former Martin Luther King, Jr. Elementary School (MLK) continues to make great strides forward. At a public meeting at the Valley School on October 28, state reps. Sharon Tomiko Santos and Eric Pettigrew (WA-37) announced the state's commitment to creating a community facility at MLK. They announced that \$1 million in state funds are available for "the acquisition, rehabilitation, expansion, or improvement of surplus school buildings to be converted into community facilities for the delivery of nonresidential coordinated services for children and families." Tomiko Santos and Pettigrew emphasized that any recipient of the grant money must have sufficient capacity to follow through on a plan. Representatives from First AME Church, Citizens for a Community Center at MLK (CCC@MLK) and the Bush School were at the meeting.

Meanwhile, another City of Seattle's School Use Advisory Committee (SUAC) meeting is scheduled for 7:00 p.m. on Thursday, November 20 at T.T. Minor Elementary (17th Ave. E and E Union St). This should be the last meeting dedicated to setting zoning and conditions for future use of MLK. An additional, final meeting will likely take place in December to approve the final SUAC report. At a previous meeting, the SUAC also set for the site operating hours of 6:00 a.m. to 10:00 p.m. with sixteen exceptions each year when events could run until midnight.

The SUAC process does not decide what will happen at MLK. Its role is to only set the zoning for what the community would allow and accept. The next steps are twofold. First, the Seattle School District will begin public hearings, probably this winter. (We'll inform you.) After, they will open up the process to proposals.

CCC@MLK, with input from the community, plans to submit a proposal. CCC@MLK's vision is for a multi-use facility offering community meeting space, arts, education, and development programs for children, families and seniors. The building will likely include a performing arts stage, dance studio, community meeting space and kitchen, and a public playground. Revenue would be generated by renting meeting space, offices for nonprofit community groups, and perhaps artist work studios. CCC@MLK's proposal includes strong backing from the larger community, commitments from various partners, and a strong emphasis on programming for children and families.

We have a great committee, but we still have a lot of projects where we need assistance:

- Website design and hosting;
- Planning and running an "Art+Change" lecture series this winter;
- Planning and hosting a holiday fundraising celebration; and
- Drafting our plan, organizational structure, and bylaws.

This is a fun project, and we need the community's help to make this happen. To learn more about how you can help, or to receive our monthly e-newsletter, contact Andy Engelson at aengelson@speakeasy.net or 484-9823.

**CAPITOL HILL
HANDYMAN**

JOHN PIERCE
310 23rd Ave East | Seattle Washington 98112
206 354 5395 | john@capitolhillhandyman.com
CAPITHH9348Z

we're a madison valley-based business!

Juxta Prose

- ▶ need a new website? www.juxtaprose.com
- ▶ changes to your existing site? info@juxtaprose.com
- ▶ contact us, we'd love to help 206.324.3147

create : experience : design : connect



**Lifelong
Easy Breathing**

With **BUTEYKO**, a natural method
Safe, Successful Help for Breathing Problems

PIPPA KIRALY, Certified Buteyko Practitioner
Buteyko Institute of Breathing and Health
(206) 329-6604
info@lifelongeasybreathing.com
www.lifelongeasybreathing.com



Let us complete you

kismet

madrona's aveda salon and spa
salonkismet.com 206.860.0323



EPIPHANY SCHOOL
Pre-Kindergarten - 5th Grade

*A community inspiring leadership
through the values of Respect,
Resourcefulness and Responsibility.*



3710 East Howell Street (206)323-9011 www.epiphanyschool.org

What's Up on Madison

By Ann McCurdy

We have art, we have yoga, and now we have music! The **Music Factory** (2803 E. Madison St, behind Voilà!) is a brand-new music educational facility offering private lessons in Guitar, Bass, Mandolin, Cello, Violin, Piano, Banjo, as well as Woodwinds, Brass, and more. Run by notable local artists the Music Factory promises to import the best teachers Seattle has to offer. Artists work with both children and adults, and will also be available for hire for private parties and events. They'll be open seven days a week from noon to 9 p.m. Leave messages at 722-1075. Welcome to the neighborhood!

Has there been a cheery sparkle in your eye? Perhaps it's the new holiday lights shining in the trees along Madison. The **Madison Valley Merchants Association** decided to pay for festive holiday lights this year, which should be installed as of November 5. If you like them, let the shop owners know!

In these dreary economic times, it's a joy to say, "Happy anniversary!" to some of our local businesses. **Bella Dolce Bakery and Café** (2711 E. Madison St.) turned five last month, while granddaddy **City People's Garden Store** (2939 E. Madison St.) celebrated their 20th anniversary with a big sale, cake, and free pumpkins for the kids. My son now has three pumpkins for Halloween—I need to start carving!

And, **Sugarlump Children's and Maternity Consignment** (2709 E. Madison St.) is turning one! Come celebrate with them on November 21 and 22. There will be lots of special sales, cupcakes, and balloons.



kids • maternity • consignment • gifts
2709 east madison street
206 • 860 • 5083
sugarlumpshop.com

THE VALLEY SCHOOL

Pre-K through 5th grade
Child-centered programs
Creative, intellectually stimulating curricula
Challenging elementary academics
Small, caring community
We are committed to each child.

OPEN HOUSE
Thurs., Feb. 5, 2009 at 7 p.m.
Tours available. Call for details.

309 31st Ave. East
Seattle • 206-328-4475
www.thevalleyschool.org



an established yet vibrantly new neighborhood

Painting by James W. Sutherland

Top 10 Reasons to Shop in **MADISON VALLEY**

1

5 BLOCKS ~ OVER 50 BUSINESSES
Unique Gifts for everyone on your list

2

FINE DINING
Café Flora, Rover's, The Harvest Vine, Crush, Nishino's, Chinoise, Voilà!

3

NUMBER OF CHOICES TO SIT AND SIP
Bella Dolce, Essential Bakery Café, My Coffeehouse, Arosa Café, Oh! Chocolate, La Côte, Voilà!, Bottleneck Lounge

4

BEST CONSIGNMENT IN TOWN
Fury Extraordinary Consignment, Gentlemen's Consignment, Sugarlump Children and Maternity Consignment

5

MORE SPECIALTY STORES THAN EVER
Istina, Birth and Beyond, Plum Children's Shoes, Real Card Company, Sweet Petula, Henrietta's Hats, Tricoter, Canopy Blue, Missi Lu

6

GIVE THE GIFT OF SERVICE
Seattle Law Office, Thrive Art School, Designed Dinners, Coyote Central Art School

7

A UNIQUE WELLNESS COMMUNITY
Bailey-Boushay House, Four Seasons Oasis, Lifelong Easy Breathing, Glow Natural Health Center, Santosha Yoga, Conscious Body Pilates, Seattle Naturopathy, Peahi Pilates, Sount Mental Health

8

A GREAT PLACE TO KEEP LOOKIN' GOOD
Frenchy's Day Spa, Marie Rodriguez Salon, Hoa Salon, Hair by Boyce, Kate's Day Spa

9

HOME DECORE GALORE
Baas Art Gallery & Framing, Apogee, Red Ticking, Veritables, Swedish Heirlooms, Rue de Lyon, Fast Frame, City People's Garden Store, Lavender Heart

10

FREE PARKING
"Avoid the Mall. We have it all"

* www.madisonvalleyonline.com *

Located near the Arboretum
on E. Madison Street between
23rd Ave. East and Lake Washington Blvd.



The Valley View - Greater Madison Valley Community Council
 P.O. Box 22278
 Seattle, WA 98122

Non-Profit Org.
 U.S. Postage
 PAID
 Seattle, WA
 Permit No. 6873

Grounds Cleanup at MLK on Saturday, November 22

By Kimberly Larson-Edwards

Anyone living, walking, biking, or driving near Martin Luther King, Jr. Elementary School (MLK) cannot help but notice the dire need of grounds work on the property. While the School District has been occasionally mowing the grass and repairing broken windows, much more is needed to improve the grounds.

On Saturday, November 22 from 9:00 a.m. to 11:00 a.m., Citizens for a Community Center at MLK (CCC@MLK) and other Madison Valley volunteers will meet up with School District staff to clean up the grounds of MLK. Through their Self-Help Projects Program, the School District will provide a gardener (to make sure we don't cut the wrong things!) as well as gloves, some tools, and bags. One step towards making the dormant school a community asset is by cleaning it up!

Please e-mail Kimberly Larson-Edwards at kimberlyvotes@gmail.com if you plan to attend the cleanup. We need many hands (and extra tools) to cut back the bushes, rake leaves, and clean up the litter. We're also looking for help before the day of the cleanup distributing flyers and getting donations for baked goods, and coffee and juice.



Come to our next Community Council meeting! Get involved. All are welcome!

Topics include:

- Community Potlucks
- Latest on SPU's flooding proposals
- What will happen to MLK School?

Wednesday, November 19, 7:30pm
The Bush School
 (Entrance on E. Harrison St. and 34th Ave. E)

Do you like our local businesses? Can you make a handful of phone calls or e-mail letters each month? We could use a few more people to help find ads for the Valley View. You don't need to find ALL of our ads, just a couple! If you'd like to help out, please contact me at editor@madisonvalley.org.

206-722-1075

**The Music Factory
 Madison Valley**

coming this fall / november
 GUITAR, BASS, BANJO, VIOLIN, PIANO + MORE!
 Lessons, Live Music Ensembles for Hire, Web Based Music Services
CHRISTMAS GIFT CERTIFICATES ON SALE NOW

THE MUSIC FACTORY
 MADISON VALLEY
 2803 E. Madison

ALL AGES - ALL STYLES - ALL LEVELS

City People's
garden store + landscape design

2939 E Madison St
 Seattle, WA 98112

Garden Store: 324-0737
 Landscape: 324-0963



2808 E. Madison St.
www.rovers-seattle.com
 206-325-7442

Friday Lunch 12:00PM - 1:30PM:
 A La Carte Options from \$8 - \$24 & 3-Course Menus

Tue - Thu Evenings From 6:00PM,
Fri - Sat Evenings From 5:30PM:
 A La Carte Options from \$9 - \$24 & Price-Fixed Menus